

Diaphragm Pump 2002 VD DC

Flow	380 ml/min
Max. pressure	400 mbar
Max. vacuum	40 %

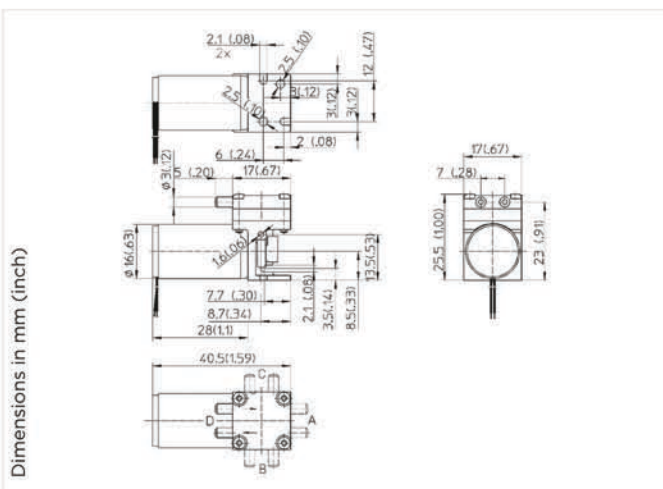

АНАЛИТИКА-СЕРВИС



PNEUMATIC DATA

Description	2002VD/0.5/E/DC	
Part number	3.5 V	20020301 (2 to 3.8 V)
	4.5 V	20020304 (3.5 to 7 V)
	6.0 V	20020307 (5 to 10 V)
Max. flow	380 ml/min	
Max. intermittent duty	380 to 400 mbar	
Max. continuous pressure	150 mbar	
Max. restart pressure	150 mbar	
Max. vacuum	36 to 40 %	
Max. restart vacuum	15 %	

ELECTRICAL DATA

Motor type	Ironless core DC
Power consumption	2 to 3.8 V/96 to 200 mW
	3.5 to 7 V/112 to 259 mW
	5 to 10 V/115 to 250 mW
Protection class	IP00
Bearing type	Sleeve bearing

GENERAL DATA

Ambient temperature	10 to 50 °C
Media temperature	10 to 50 °C
Weight	32 g
Port direction	D

Noise suppression for the purpose of guideline 89/336 EWG electromagnetic tolerance.

FLOW CURVES

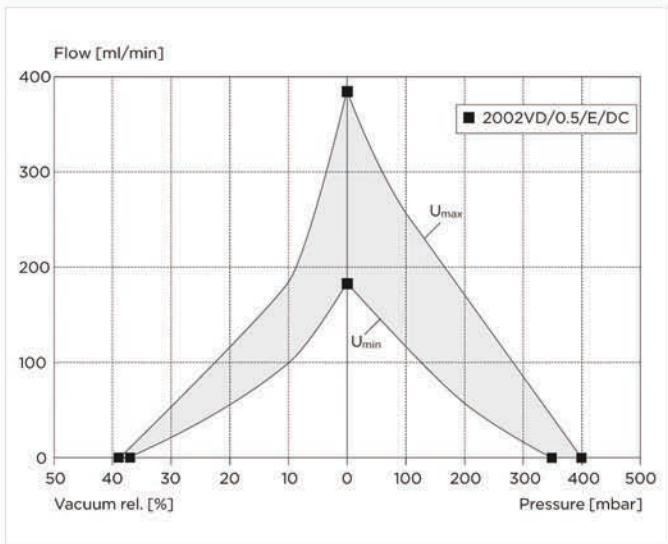

WETTED PARTS

Pump head	PF	
Diaphragm, valves	EPDM	FKM, Silicone

OPTIONS

2002... Stock programme

Bearing type: Ball bearing

Model key:

